

GF210

21"/54 cm

Gas-Powered Ventilator

Tried and true, tested and trusted, conventional ventilators have stood the test of time. The GF series are the PPV fans that helped to build the RAMFAN brand in the industry and these feconomical gas fans are well known for their durability.

Compact with outstanding close range ventilation using TurboForce™ technology to generate stronger, faster and more focused airflow than possible with conventional propeller designs. With the large amount of airflow, the fan is powerful enough to use for large structure ventilation.

Specifications

Model	GF210
Part	GE5001
Weight	88 lbs / 40 kg
Impeller	7-Blade
Dimensions (h/w/d)	24.8 x 25.3 x 22.4 in / 63 x 64.3 x 22.4 cm
Engine	Honda GX160 4.8 Hp / 3.5 kW
Noise	96 dB@3' (1 m)
Run Time	1 hr 26 min
Approval	CE

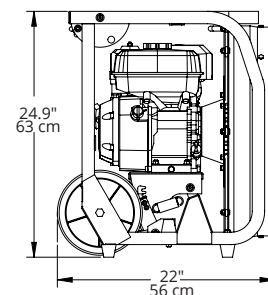
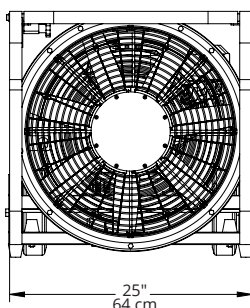
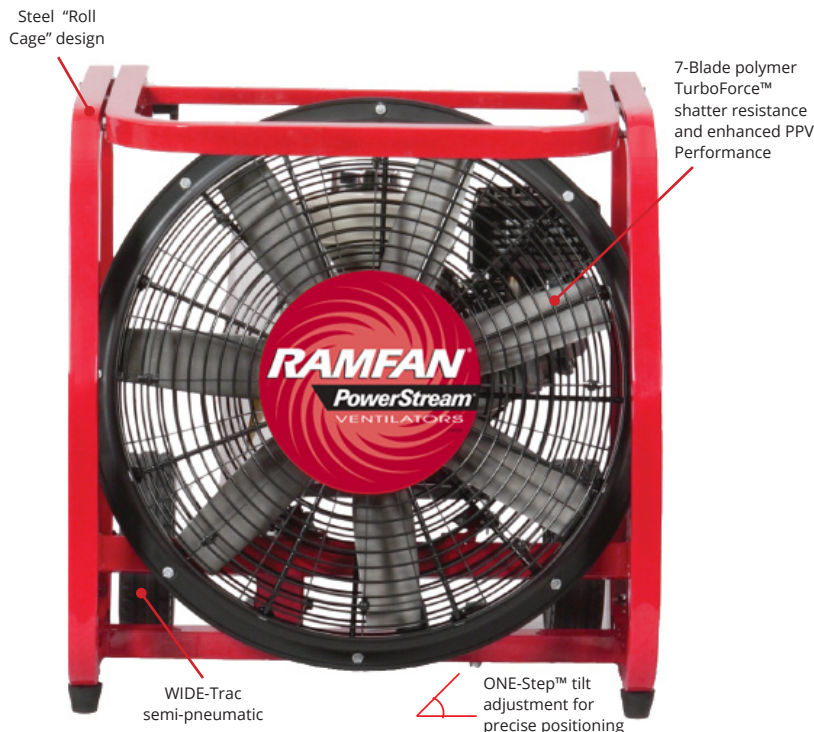

Performance

Airflow	
Opening Size (Single Door)	17,670 cfm (30,039 m³/hr)

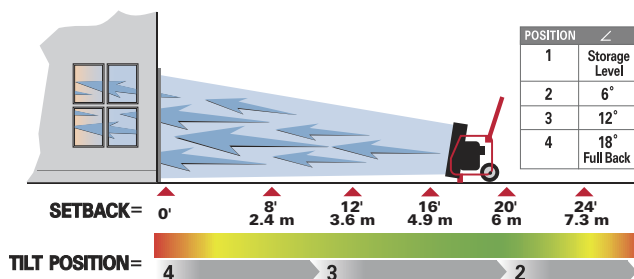

Available Accessories

Integrated Misting System

1.85 gal/min @ 100 psi
7 l/min @ 6.9 bar
Order # GE8111

Exhaust Diverter Hose

2" x 12' (5 cm x 3.6 m)
Order # GF7115

BigBore™ Exhaust Diverter Adapter

Muffler Fitting
Order # GF7120-BZ
Compatible with Honda motors

Hour Meter

GX Series
Order # GX1515
"Keep track of regular scheduled maintenance"



Integrated Misting System



BigBore™ Exhaust Diverter Adapter



Exhaust Diverter Hose



Hour Meter